

Windy's Corner

6033 NE Win Silvers Drive, Portland, OR 97220

This shopping center is located within 2 miles East of Portland International Airport on a very busy corner with high traffic counts. Surrounding this property are many industrial employers and hotels. Neighboring tenants include Plaid Pantry, Salon Centric and Sidelines Sports Bar.



AVAILABLE:

2,580 SF
Former Restaurant

The space can be demised as follows:

Suite C—1,016 SF

Suite D—1,564 SF

\$26.00 SF/Year plus NNN
Approximately \$13.00 SF/NNN

Craig Barnard

503.675.0900 | craig@barnardcommercial.com

www.barnardcommercial.com | Mail: 5200 Meadows Road, Suite 150, Lake Oswego, OR 97035

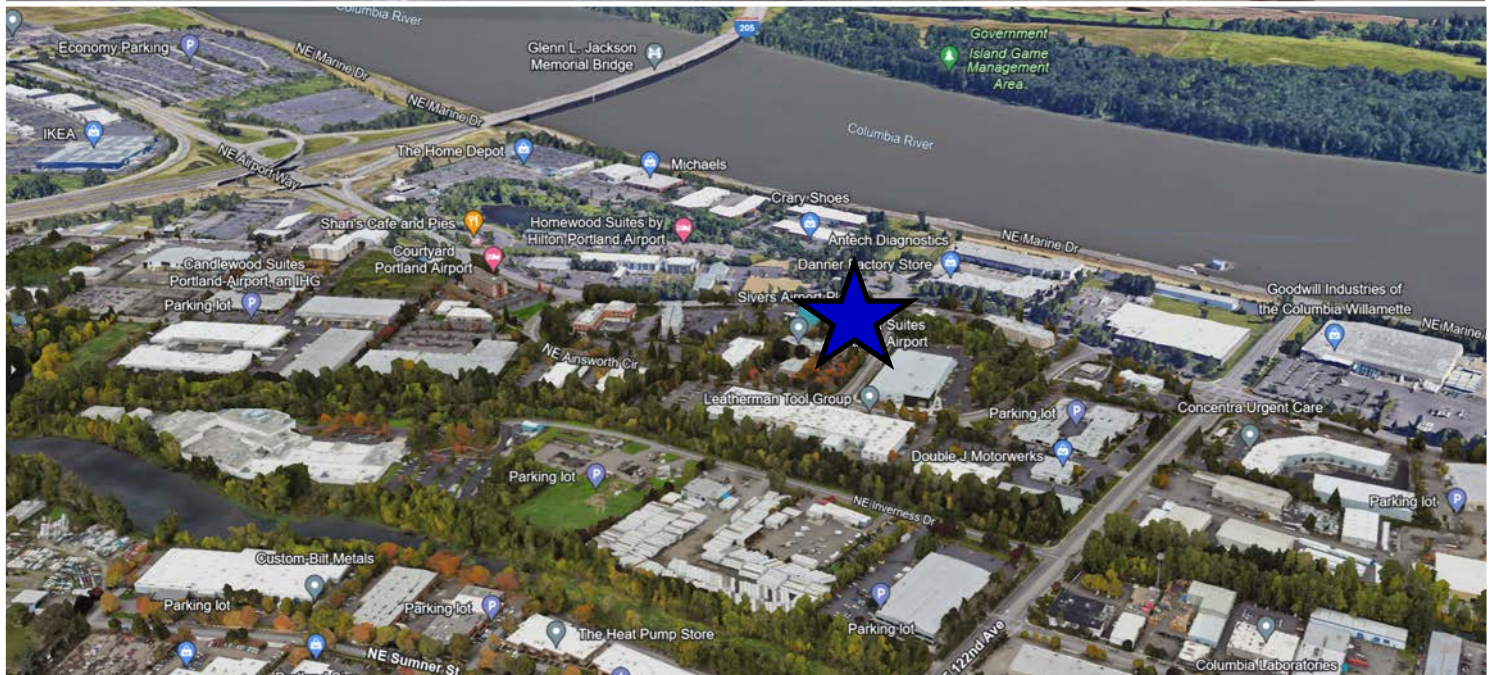

Craig Barnard

503.675.0900 | craig@barnardcommercial.com

www.barnardcommercial.com | Mail: 5200 Meadows Road, Suite 150, Lake Oswego, OR 97035

All information contained herein was obtained from sources deemed reliable. No guarantee is made with respect to accuracy. Specifications subject to change without notice.



Demographic Information

	1 Mile	3 Mile	5 Mile
Population:	3,038	70,327	314,416
Average HH Income:	\$62,939	\$88,770	\$93,047

Average Daily Traffic:

NE Airport Way, West of Win Sivers Drive - **32,092**

NE Airport Way, East of Win Sivers Drive - **37,280**

Craig Barnard

503.675.0900 | craig@barnardcommercial.com

www.barnardcommercial.com | Mail: 5200 Meadows Road, Suite 150, Lake Oswego, OR 97035



Craig Barnard

503.675.0900 | craig@barnardcommercial.com

www.barnardcommercial.com | Mail: 5200 Meadows Road, Suite 150, Lake Oswego, OR 97035

All information contained herein was obtained from sources deemed reliable. No guarantee is made with respect to accuracy. Specifications subject to change without notice.

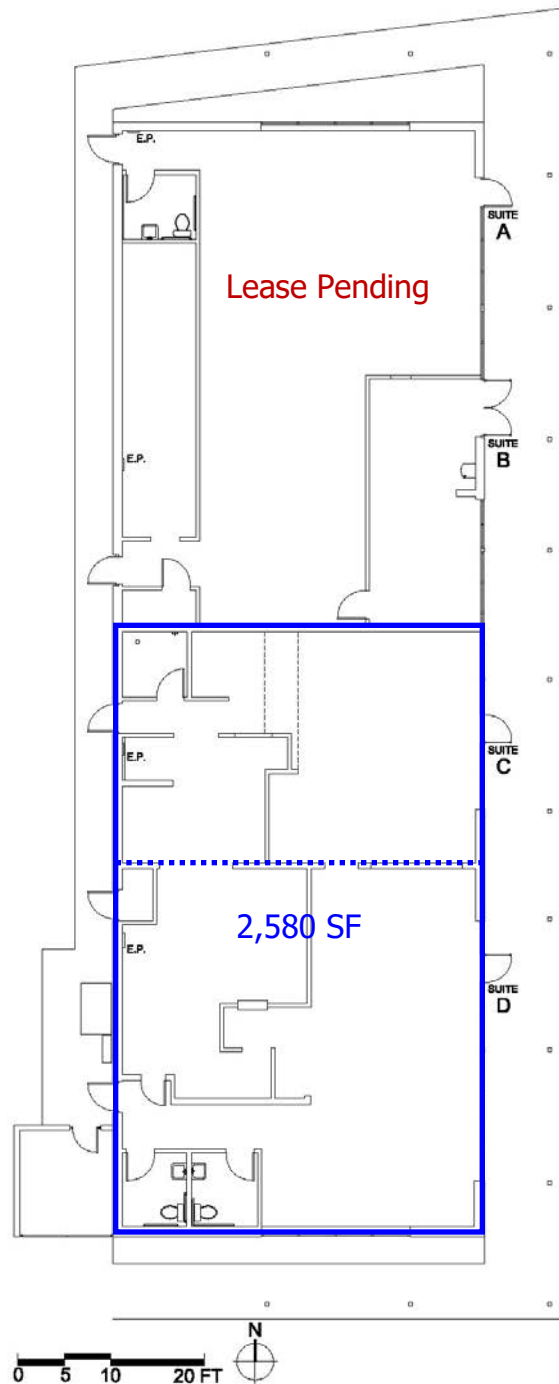

Oregon Business Architecture P.C.
P.O. Box 80301 Portland, Oregon 97280
T: 503 / 228-9747 F: 503 / 228-5721

WINDY'S CORNER
6033 NE WIN SIVERS DR.
#14011 04/17/24

Craig Barnard
503.675.0900 | craig@barnardcommercial.com
www.barnardcommercial.com | Mail: 5200 Meadows Road, Suite 150, Lake Oswego, OR 97035